

# GK8390M

NO	DESCRIPTION	NO	DESCRIPTION
1	Engine	57	Left Member
2	Nut M8	58	Right Member
3	Nut M6	59	Nut M8
4	Throttle control	60	Chain assembly
5	Bolt M6×45	60-1	Nut M6
6	Throttle cable	60-2	Plut
7	Handle	60-3	Busing
8	Plast handle	60-4	Right Chain case
9	Clutch handle	60-5	Bearing 6003 2RS
10	Clutch cable	60-6	Small sprocket shaft
11	Clutch cable	60-7	Chain
12	Adjust handle	60-8	Bearing 6206 2RS
13	Adjust the handle gasket	60-9	Big sprocket shaft
14	Middle gear set	60-10	Left Chain case
15	Armrest	60-11	Bolt M6×14
16	Nut M8	61	Bushing
17	Bolt M8×20	62	Bushing
18	Nut M8	63	Left protective plate
19	Depth skid support	64	Big protective plate
20	R type pin	65	Bolt M5×12
21	Bolt M8×20	66	Right protective plate
22	Depth skid	67	Nut M5
23	Nut M8	68	Side discs
24	Bolt M8×16	69	Nut M8
25	Shaft	70	Tube outer
26	Bolt M8×40	71	Cotton φ10*50
27	Bolt M8×16	72	blades right
28	Bolt M8×16	73	R type pin
29	Belt protection bracket	74	blades left
30	Nut M8	75	Tube middle
31	washer φ8	76	Bolt M8×20
32	Back tension wheel assembly	77	tube straight
33	washer φ8	78	Bushing
34	Bolt M8×35	79	Bolt M8×25
35	Nut M8	80	Bolt M8×40
36	Belt protection sheet	81	bushing
37	follower pulley	82	nylon gear
38	washer φ8	83	driving pulley
39	Nut M8	84	Flat key
40	Bolt M8×25	85	Washer φ8
41	washer φ8	86	Bolt M8×25
42	Forward tension wheel assembly	87	Screw M6*10
43	Tension spring	88	Bushing
44	Ladder bushing	89	Cotter pin
45	washer φ8	90	Big Pulley
46	Nut M8	91	Reverse belt
47	Support plate	92	Forward belt
48	Bolt M10×60	93	Belt cover
49	washer φ10	94	Bolt M5×25
50	wheel shaft bushing	100	Knives R Assembly
51	Front wheel	110	Knives R Middle Assembly
52	Nut M10	120	Knives R straight Assembly
53	Cotter Shaft	130	Knives L straight Assembly
54	Front wheel bracket	140	Knives L Middle Assembly
55	R type pin	150	Knives L Assembly
56	Bolt M8×45		

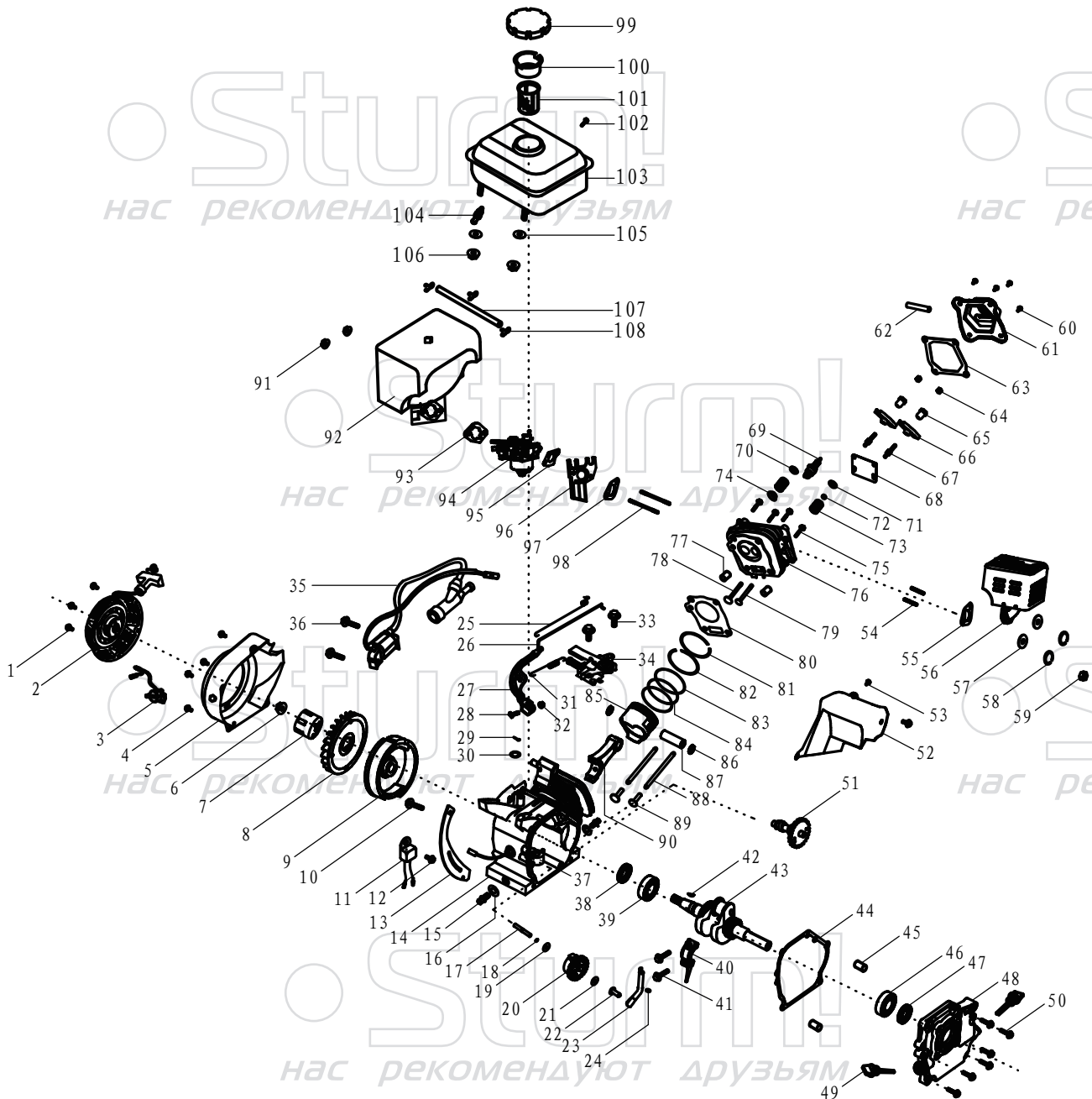

## Engine for GK8390M

NO	DESCRIPTION	NO	DESCRIPTION
1	bolt M6×7	55	muffler gasket
2	pull starter assy.	56	muffler
3	engine switch	57	washer φ8
4	bolt M6×12	58	spring washer φ8
5	engine cover	59	nut M8
6	Nut M14	60	bolt M6x12
7	starter cup	61	cylinder head cover
8	fan	62	breath pipe
9	fly wheel	63	cylinder head gasket
10	bolt M6x16	64	locking nut
11	separator	65	Adjusting nut
12	bolt M6×12	66	rock arm
13	fly wheel side cover	67	rock arm bolt
14	Crank box	68	guide board
15	bolt M10x12	69	spark plug
16	washer φ10xφ16x1	70	intake valve spring base
17	rate-limiting gear shaft	71	exhaust valve spring base
18	CIRCLIP φ6	72	top cover
19	washer φ6xφ15x0.5	73	vlave spring
20	rete-limiting gear assy.	74	valve oil seal
21	washer φ6xφ15x0.5	75	bolt M8x55
22	Sliding Sleeve	76	cylinder head
23	Swinging rod	77	pin φ10×14
24	washer φ6	78	intake valve
25	Reset tension spring	79	exhaust valve
26	Speed control lever	80	cylinder head gasket
27	Control arm	81	1st piston ring
28	square bolt	82	2nd piston ring
29	spring pin	83	piston ring a
30	washer φ6	84	piston ring b
31	Speed control tension spring	85	piston
32	Nut M6	86	piston pin circlip
33	Bolt M6x12	87	piston pin
34	Speed control base	88	push rod
35	ignition	89	rod
36	bolt M6x25	90	connect rod
37	oil alert system	91	Nut M6
38	oil seal	92	air filter
39	bearing 6205	93	air filter gasket
40	connect rod cover	94	carburetor
41	connect rod bolt	95	gasket
42	key	96	block board
43	crankshaft	97	gasket
44	Crank box gasket	98	Double bolt
45	pin φ18×14	99	fuel tank cap
46	bearing 6205	100	filter clip
47	oil seal	101	fuel filter
48	Crank box cover	102	bolt M6x28
49	oil plug	103	fuel tank
50	bolt M8x33	104	Fuel pipe connector
51	camshaft	105	plastic gasket
52	cool guide board	106	nut M6
53	bolt M6x12	107	fuel pipe
54	double bolt	108	clip